



15 King William Street Fitzroy VIC

3  2  1 

Sale in conjunction with Walshe & Whitelock : David Sowersby 0419 311 775

A classic and charming Fitzroy Terrace comprising 3 bedrooms, 2 bathrooms with comfort and convenience.

Reminiscent of an English Georgian 1800 Terrace Home, seize the opportunity to reside in a chic location and create a characterful home. Split over 2 levels, enjoy 3 generous sized bedrooms, with ultra-high ceilings, tiled bathrooms, a large cellar, separate living with split system air con, spacious kitchen/meals area opening to north facing courtyard and rear access to ROW.

With such an array of iconic hotspots nearby, you're definitely in for a treat? the lush greenery of Carlton Gardens to the trendy Brunswick and Gertrude Street precincts, The Royal Exhibition Building, stroll to Bonny, St Andrews Hotel, Mon Ami or any of the local haunts. All transport options nearby or ride your bike to the city.

Price : \$1,740,000

View : <https://www.kellyshiel.com.au/sale/vic/inner-city/fitzroy/residential/house/8011004>

15 King William Street, Fitzroy

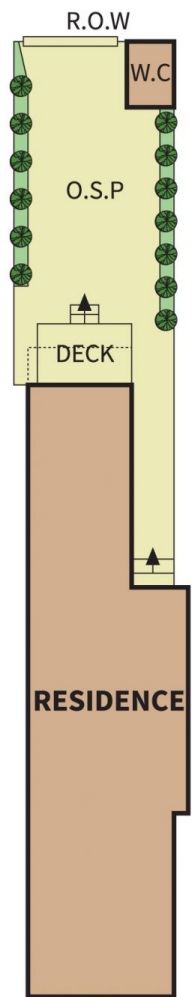
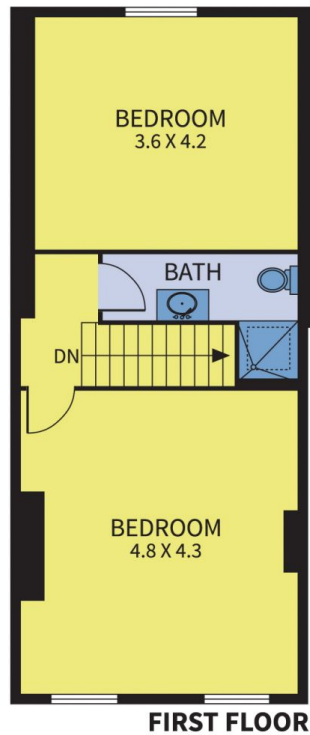
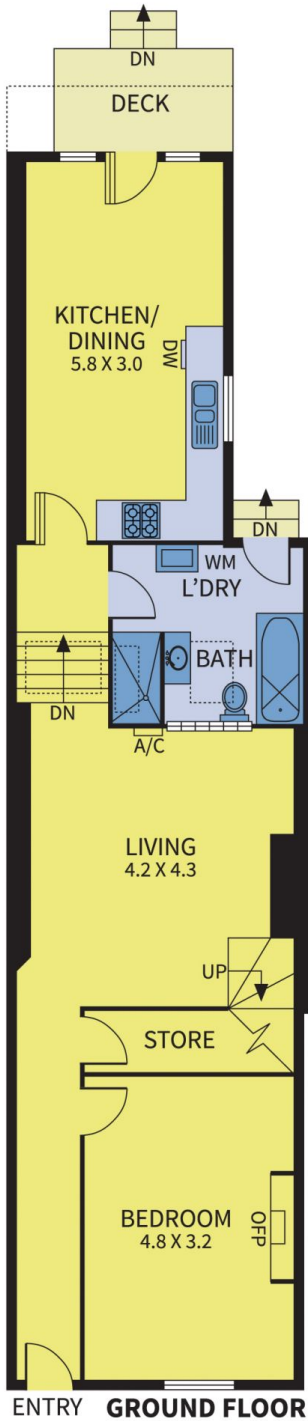

Every care has been taken to verify the accuracy of details in this Floorplan.
Prospective purchasers and tenants are requested to take such action as is necessary to satisfy themselves of any pertinent matters.
Note: This Floorplan has been provided for marketing purposes only.

Not to Scale